

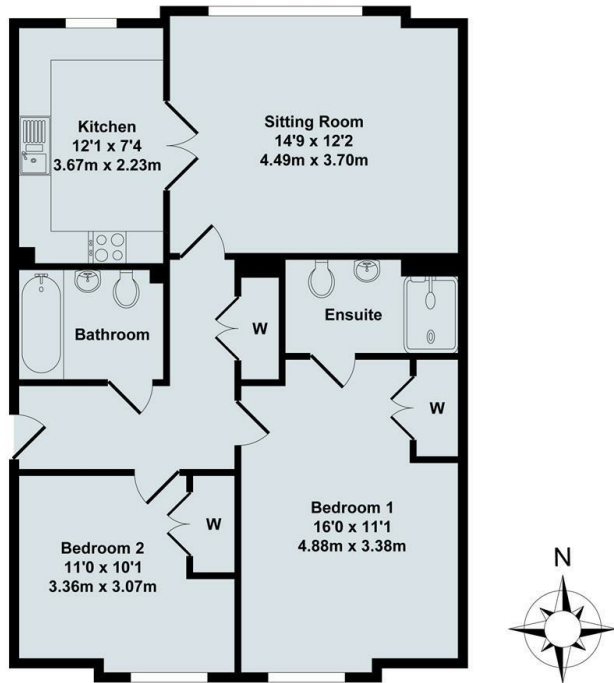

## 14 Priory Court, Jackson Road, Oxford, Oxfordshire, OX2 7UW

£1,700 PCM - 29th June 2026.

- Two bedrooms
- Gas CH
- Council Tax Band C
- Two bathrooms
- Parking for 1 car
- Mains gas, electricity and water
- Fully furnished
- EPC rating C



Total Approx. Floor Area 741 Sq.Ft. (68.80 Sq.M.)  
 All items illustrated on this plan are included in the "Total Approx Floor Area"

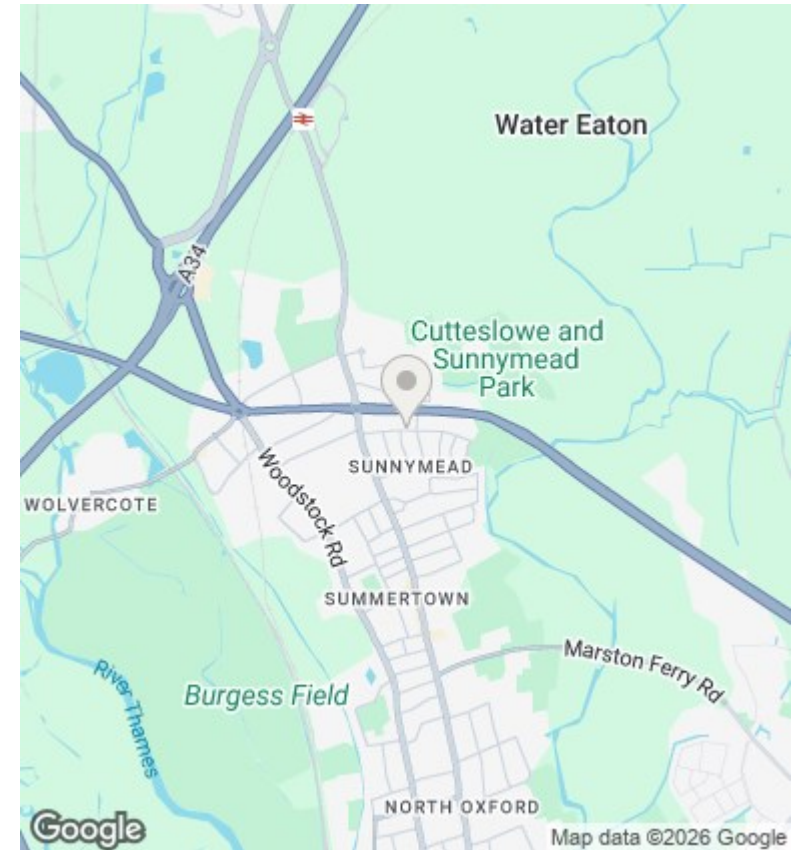

### Directions

### Viewings

Viewings by arrangement only. Call 01865 515900 to make an appointment.

### Council Tax Band

C

### EPC Rating:

C

Energy Efficiency Rating		Current	Potential
<i>Very energy efficient - lower running costs</i>			
(92 plus) <b>A</b>			
(81-91) <b>B</b>			
(69-80) <b>C</b>		78	80
(55-68) <b>D</b>			
(39-54) <b>E</b>			
(21-38) <b>F</b>			
(1-20) <b>G</b>			
<i>Not energy efficient - higher running costs</i>			
<b>England &amp; Wales</b>		EU Directive 2002/91/EC	